

x1



x2



x2



x2



x2

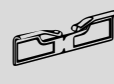

x1



x2



100
lb

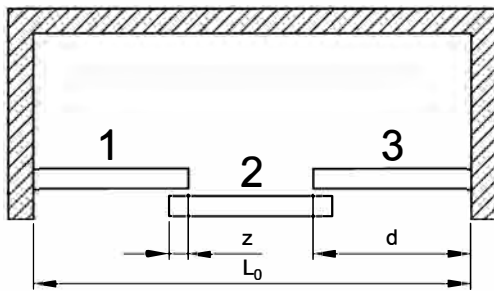

$$d = (L_0 + 2z) / 3$$

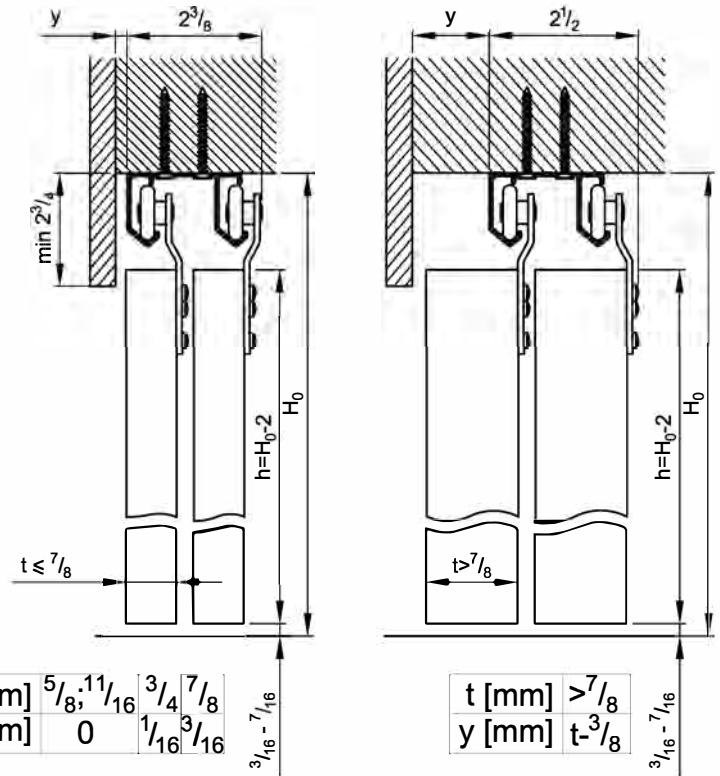

t [mm]	5/8, 11/16	3/4, 7/8
y [mm]	0	1/16, 3/16

t [mm]	> 7/8
y [mm]	t - 3/8

1

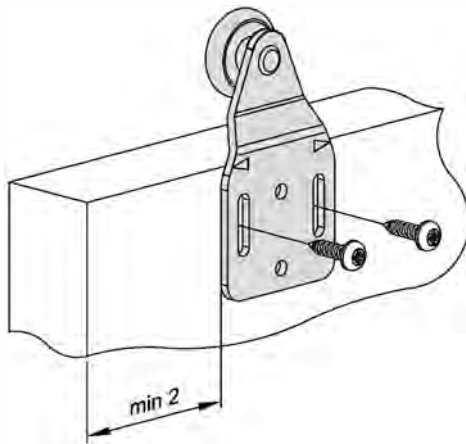

2

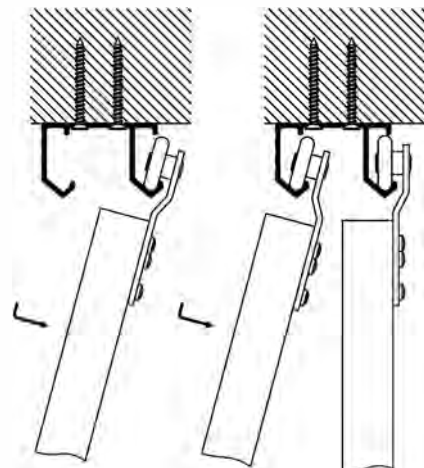

3

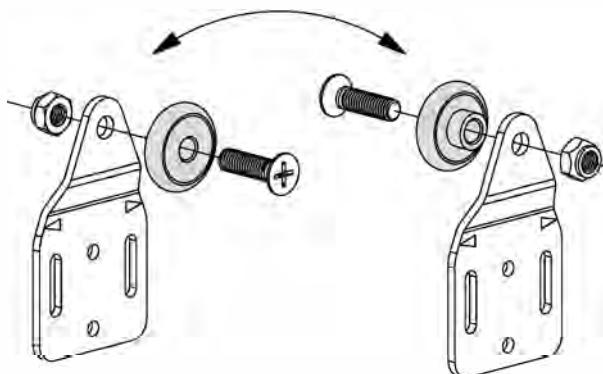

4

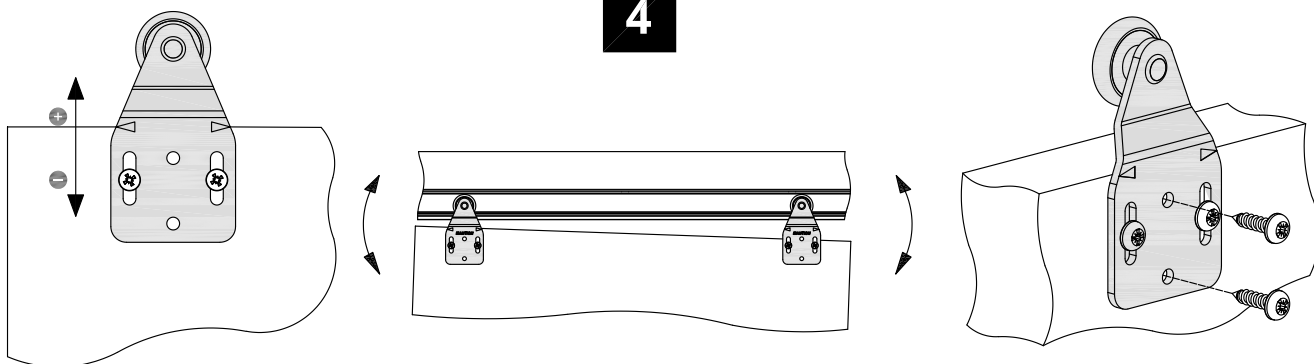

5

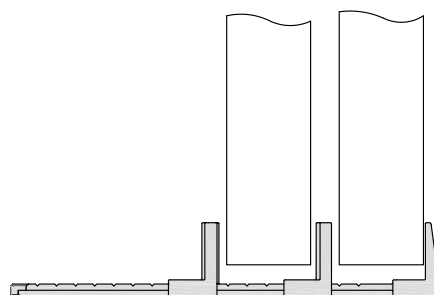
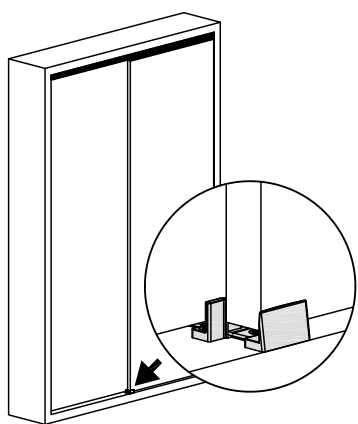

6

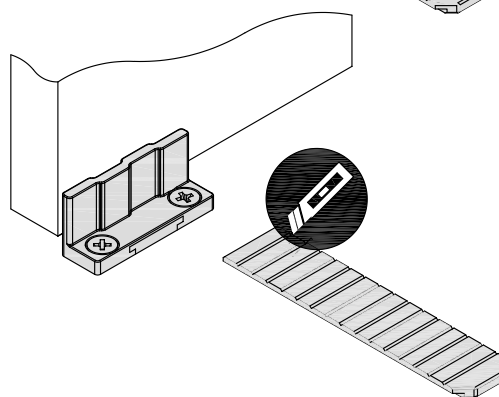
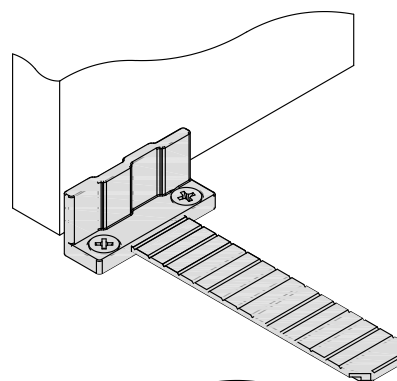
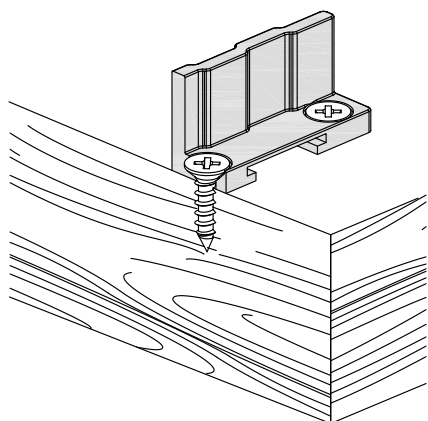

7

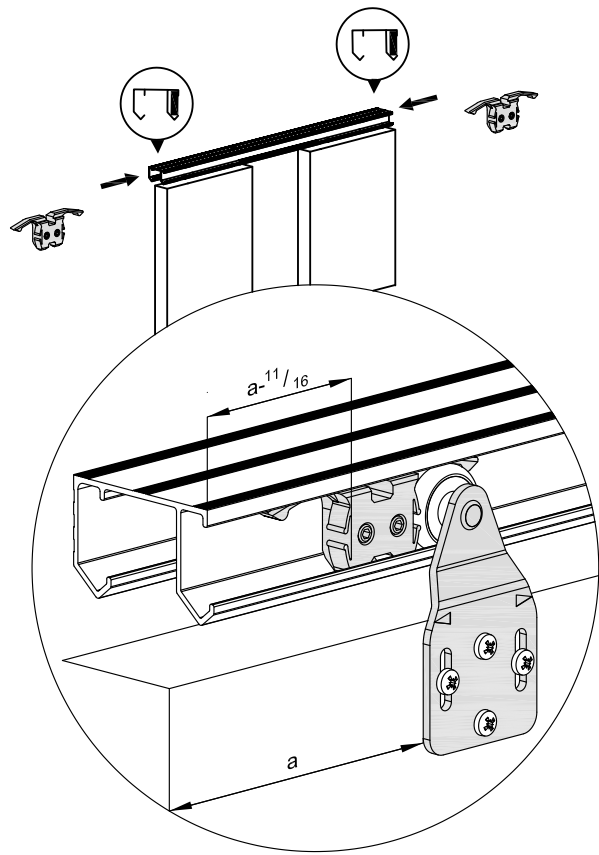
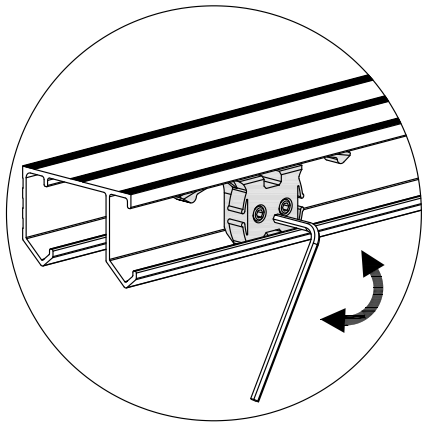

8

